

ESU LokPilot Recommended Settings for Marklin Locomotives

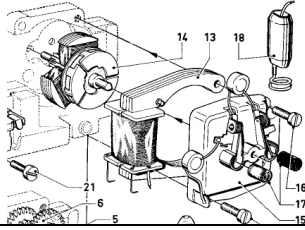

Märklin® Small Flat Commutator Motor

CV 2 = 6
CV 53 = 20
CV 54 = 16
CV 55 = 12

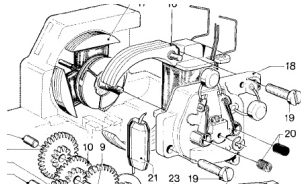

Märklin® Large Face Commutator Motor

CV 2 = 6
CV 53 = 50
CV 54 = 16
CV 55 = 12



Märklin® Drum Commutator Motor

CV 2 = 6
CV 53 = 40
CV 54 = 16
CV 55 = 12



Märklin® Loco with Maxon Motor

CV 2 = 4
CV 53 = 56
CV 54 = 6 - 8
CV 55 = 4 - 6